



Roseville Street, St. Helier





£410,000



01534 888 139 · info@huelinhomes.com



At a glance

-  2 Bedrooms
-  1 Bathroom
-  1 Reception
-  0 Parking spaces

Features

- Two Bedroom House
- Quietly Tucked Away
- Town Outskirts
- Small Garden Area
- Share Transfer



01534 888 139 • info@huelinhomes.com

This attractive two-bedroom house offers comfortable and practical living, making it an ideal home for first-time buyers, small families, or those looking to downsize.

The property features two well-proportioned bedrooms and a spacious kitchen with ample storage and worktop space, perfect for everyday living. The bright and welcoming living area creates a warm and inviting atmosphere throughout the home.

Outside, there is a small private garden area, providing a pleasant outdoor space for relaxing.

A particular highlight of the property is the large floored attic, offering excellent additional storage and potential for a variety of uses, subject to any necessary permissions.

Combining practicality, space, and charm, this well-presented home offers excellent value and is ready to suit a range of lifestyle needs.

- Gas heating
- Shared communal exterior shed
- Share Transfer



01534 888 139 · info@huelinhomes.com



Huelin Homes

LETTINGS | MANAGEMENT | SALES

01534 888 139 • info@huelinhomes.com



Huelin Homes

LETTINGS | MANAGEMENT | SALES

01534 888 139 • info@huelinhomes.com



Huelin Homes

LETTINGS | MANAGEMENT | SALES

01534 888 139 • info@huelinhomes.com



Huelin Homes

LETTINGS | MANAGEMENT | SALES

01534 888 139 • info@huelinhomes.com



Floor 0

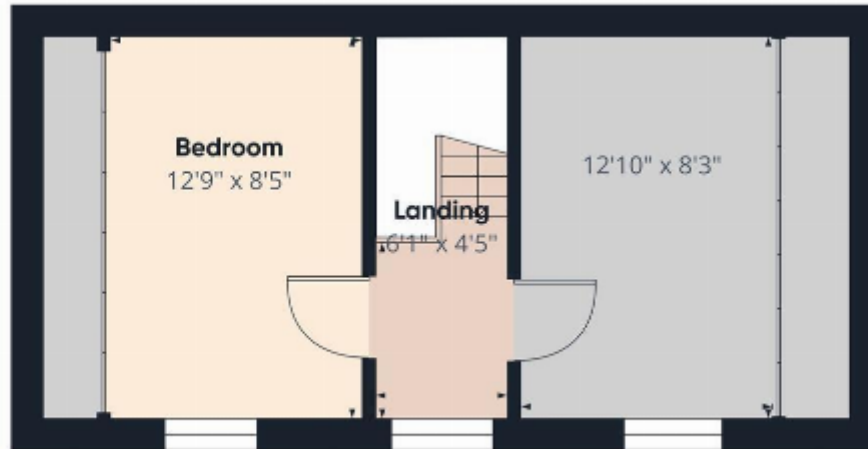

Floor 1



Approximate total area⁽¹⁾
661 ft²

(1) Excluding balconies and terraces

Calculations reference the RICS NPS 3C standard. Measurements are approximate and not to scale. This floor plan is intended for illustration only.

GRAFFIE 360



01534 888 139 • info@huelinhomes.com